

MASTERVALVE NRS F4

FIRE PROTECTION



Gate valve 2250

Product description:

- Body bonnet and wedge made of ductile cast iron EN-GJS 450-10
- Full bore gate valve
- EPDM full vulcanised wedge
- Wedge nut made of forged brass - replaceable
- Stainless steel (SS420) spindle with rolled thread
- Gasket body-bonnet profiling type o-ring
- Body bonnet stainless steel screws protected by wax
- O-ring spindle sealing by NBR
- Under pressure replaceable o-ring packing
- Epoxy coating minimum 250 microns according to EN 14901 and ANSI/AWWA C550
- Product according to EN 1074, EN 1171, FM1120/1130, VdS
- Flange connection according to EN 1092-2, pressure PN10, PN16
- Face to face according to EN 558+A1, F4, row 14
- Working Pressure PN16

Application:

Fire protection systems temperature from 0°C to +70°C

Optional types:

SS (A4) body bonnet screws

Test control:

Water pressure test according to FM, VdS, EN 1074, EN 12266
 Seat Leakage Test: 1,5 x PN
 Body Pressure Test: 2 x PN
 Operation torque

Assembling:

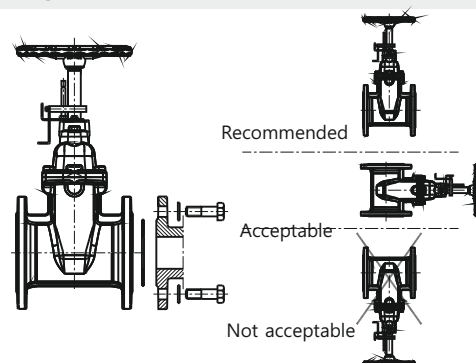

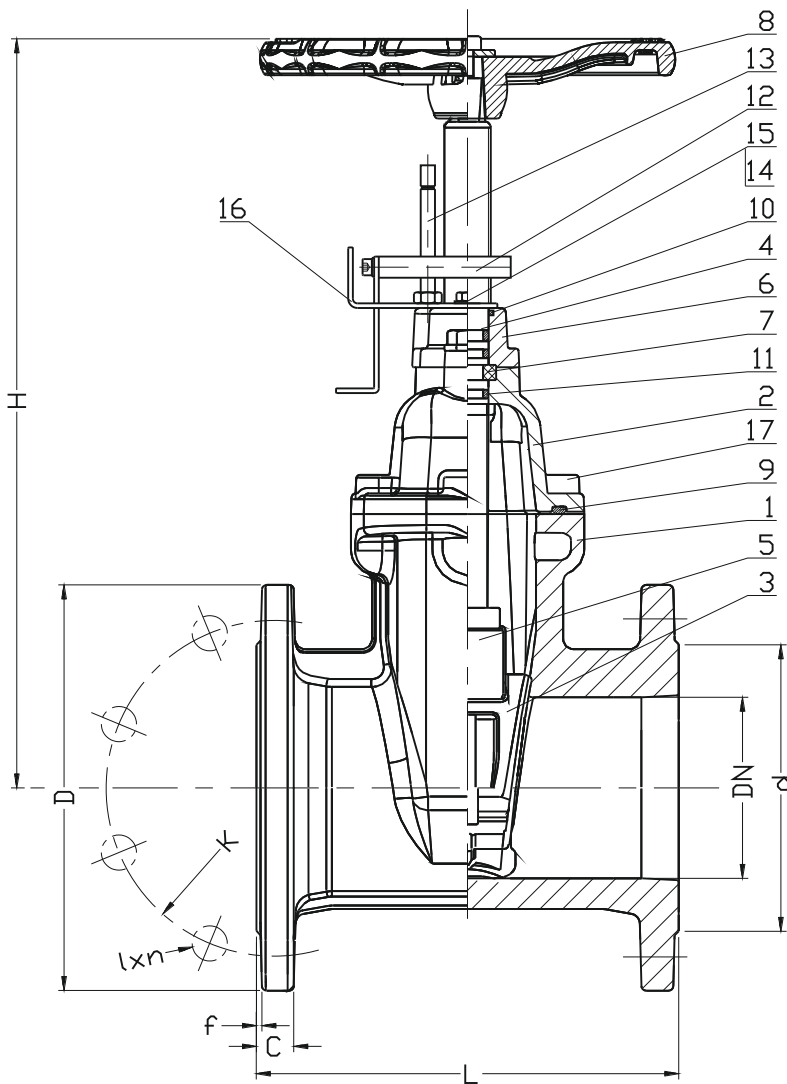

No.	Part	Material
1	Body	Ductile cast iron EN-GJS-450-10 EN 1563
2	Bonnet	Ductile cast iron EN-GJS-450-10 EN 1563
3	Wedge	Ductile cast iron EN-GJS-450-10 EN 1563 EPDM EN ISO 1629
4	Spindle	Stainless steel SS420 EN 10088-1
5	Spindle nut	Brass CuZn39Pb2
6	Gland	Ductile cast iron EN-GJS-450-10 EN 1563
7	Thrust washer	Brass CuZn39Pb2
8	Handwheel	Ductile cast iron EN-GJS-450-10 EN 1563
9	Body-bonnet gasket	EPDM EN 1629
10	Cleaning gasket	EPDM EN 1629
11	O-ring	NBR EN 1629
12	Indicator Plate	Brass CuZn39Pb2
13	Indicator Pin	Stainless steel SS420 EN 10088-1
14	Washer	Carbon steel zinc platec EN ISO 7091
15	Nut	Carbon steel zinc platec EN ISO 4032
16	Delimit	Stainless steel SS420 EN 10088-1
17	Screw	Stainless steel (SS 304) A2; EN ISO 4762

Partnumber	CE	FM	VDS	DN	PN	L	H	D	K	d	C	f	l	n	Weight	
				[mm]	[bar]	[mm]									-	[kg]
2250-0050-2E169	v	v	v	50	PN10/16	150	241	165	125	99	19	3	19	4	10.2	
2250-0065-2E169	v	v	v	65		170	255	185	145	118	19	3	19	4	12.3	
2250-0080-2E169	v	v	v	80		180	304	200	160	132	19	3	19	8	16.3	
2250-0100-2E169	v	v	v	100		190	337	220	180	156	19	3	19	8	21.1	
2250-0125-2E169	v	-	v	125		200	414	250	210	184	19	3	19	8	32.4	
2250-0150-2E169	v	v	v	150		210	436	285	240	211	19	3	23	8	42.26	
2250-0200-2E109	v	v	v	200	10	230	506	340	295	266	20	3	23	8	57.5	
2250-0200-2E169	v	v	v		16	230	506	340	295	266	20	3	23	12	57.5	
2250-0250-2E109	v	v	v	250	10	250	644	405	350	319	22	3	23	12	105.4	
2250-0250-2E169	v	v	v		16	250	644	405	355	319	22	3	28	12	105.4	
2250-0300-2E109	v	v	v	300	10	270	739	460	400	370	24.5	4	23	12	169.2	
2250-0300-2E169	v	v	v		16	270	739	460	410	370	24.5	4	28	12	169.2	

We reserve the rights to modify the production program and the given data without separate notices due to the permanent company development.

MASTERVALVE NRS GR

FIRE PROTECTION



Gate valve 2251

Product description:

- Body bonnet and wedge made of ductile cast iron EN-GJS 450-10
- Full bore gate valve
- EPDM full vulcanised wedge
- Wedge nut made of forged brass - replaceable
- Stainless steel (SS420) spindle with rolled thread
- Gasket body-bonnet profiling type o-ring
- Body bonnet stainless steel screws protected by wax
- O-ring spindle sealing by NBR
- Under pressure replaceable o-ring packing
- Epoxy coating minimum 250 microns according to EN 14901 and ANSI/AWWA C550
- Product according to EN 1074-1, EN 1171, FM1120/1130, VdS
- Grooved ends according to AWWA C606 & ISO 6182
- Face to face according to ANSI B16.1
- Working Pressure PN16

Application:

Fire protection systems temperature from 0°C to +70°C

Optional types:

SS (A4) body bonnet screws

Test control:

Water pressure test according to FM, VdS, EN 1074, EN 12266
 Seat Leakage Test: 1,5 x PN
 Body Pressure Test: 2 x PN
 Operation torque

Assembling:

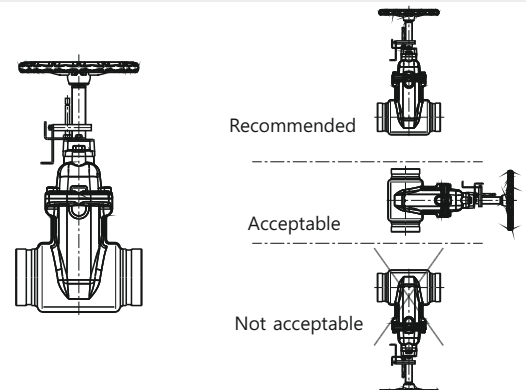

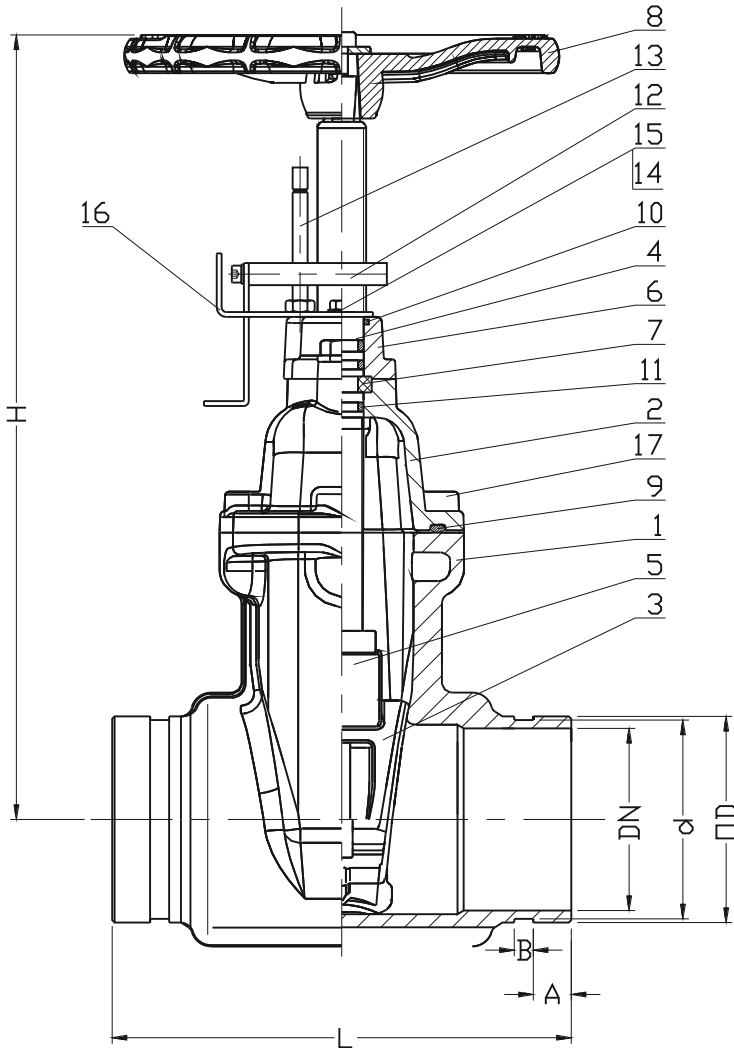

No.	Part	Material
1	Body	Ductile cast iron EN-GJS-450-10 EN 1563
2	Bonnet	Ductile cast iron EN-GJS-450-10 EN 1563
3	Wedge	Ductile cast iron EN-GJS-450-10 EN 1563 EPDM EN ISO 1629
4	Spindle	Stainless steel SS420 EN 10088-1
5	Spindle nut	Brass CuZn39Pb2
6	Gland	Ductile cast iron EN-GJS-450-10 EN 1563
7	Thrust washer	Brass CuZn39Pb2
8	Handwheel	Ductile cast iron EN-GJS-450-10 EN 1563
9	Body-bonnet gasket	EPDM EN 1629
10	Cleaning gasket	EPDM EN 1629
11	O-ring	NBR EN 1629
12	Indicator Plate	Brass CuZn39Pb2
13	Indicator Pin	Stainless steel SS420 EN 10088-1
14	Washer	Carbon steel zinc platec EN ISO 7091
15	Nut	Carbon steel zinc platec EN ISO 4032
16	Delimit	Stainless steel SS420 EN 10088-1
17	Screw	Stainless steel (SS 304) A2; EN ISO 4762

Partnumber	CE	FM	VDS	DN	L	H	OD	d	A	B	Weight
				[mm]			[mm]				[kg]
2251-0050-2E169	v	v	v	50	178	218	60.3	57.15	15.88	7.92	6
2251-0065-2E169	v	v	v	65	190	230	76.1	72.26	15.88	7.92	7
2251-0073-2E169	v	v	v	2 1/2"	190	230	73.0	69.09	15.88	7.92	7
2251-0080-2E169	v	v	v	80	203	281	88.9	84.94	15.88	7.92	10
2251-0100-2E169	v	v	v	100	229	316	114.3	110.08	15.88	9.52	14
2251-0125-2E169	v	-	v	125	254	393	139.7	135.48	15.88	9.52	28
2251-0141-2E169	v	-	v	5"	254	393	141.3	137.03	15.88	9.52	28
2251-0150-2E169	v	v	v	150	267	420	168.3	163.96	15.88	9.52	32
2251-0165-2E169	v	v	v	6"	267	420	165.1	160.90	15.88	9.52	32
2251-0200-2E169	v	v	v	200	292	490	219.1	214.40	19.05	11.13	48
2251-0250-2E169	v	v	v	250	330	626	273.0	268.28	19.05	12.70	96
2251-0300-2E169	v	v	v	300	356	722	323.9	318.29	19.05	12.70	135

MASTERVALVE OS&Y FxF

FIRE PROTECTION



Gate valve 2260

Product description:

- Body bonnet and wedge made of ductile cast iron EN 1563 EN- GJS-450-10
- Full bore gate valve
- EPDM full vulcanised wedge
- Wedge nut made of forged brass - replaceable
- Stainless steel (SS420) spindle with rolled thread - rising
- Gasket body-bonnet profiling type o-ring
- Body bonnet stainless steel screws protected by wax
- EPDM packing gland of spindle
- Epoxy coating minimum 250 microns according to EN 14901, ANSI/AWWA C550
- Product according to FM1120/1130, AWWA C509
- Flange drilling according to ANSI CL125/150 or EN 1092-2 (ISO 7005-2) PN 10/16
- Face to face according to ANSI B16.1
- Working Pressure 250/300 PSI or PN16
- Tapping bosses will have following sizes: 1/2" tapping boss: 2"(DN50)-5"(DN125), 3/4" tapping boss: 6"(DN150)-8"(DN200), 1" tapping boss: 10"(DN250)-24"(DN600)

Application:

Fire protection systems temperature from 0°C to +70°C

Optional types:

SS body bonnet screws,
With inductive or electromechanical sensors

Test control:

Water pressure test according to FM.
Seat: 1,5 x PN
Body: 2 x PN
Operation torque test

Assembling:

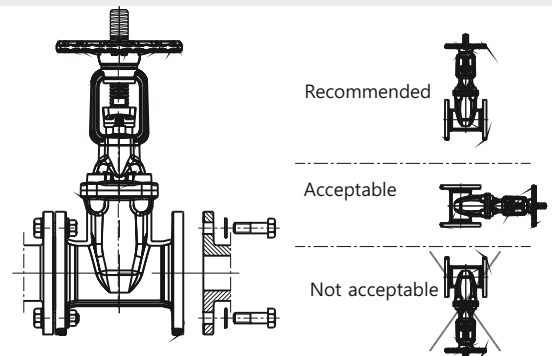

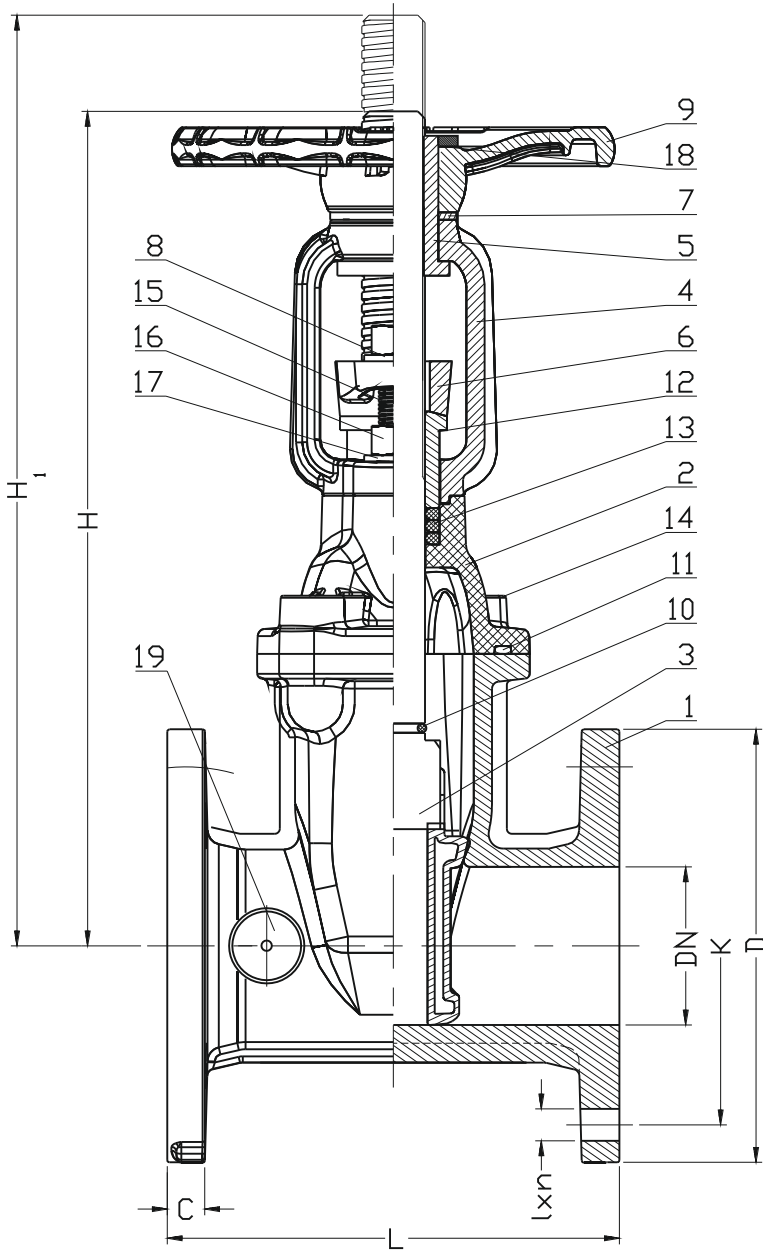

No.	Part	Material
1	Body	ASTM A536, 65-45-12 EN- GJS-450-10 EN 1563
2	Bonnet	ASTM A536, 65-45-12 EN- GJS-450-10 EN 1563
3	Wedge	ASTM A536, 65-45-12 EN- GJS-450-10 EN 1563 +EPDM
4	Yoke	ASTM A536, 65-45-12 EN- GJS-450-10 EN 1563
5	Threaded bushing	Brass CuZn39Pb2
6	Gland seal	ASTM A536, 65-45-12 EN- GJS-450-10 EN 1563
7	Spindle washer	Brass CuZn39Pb2
8	Spindle	Stainless steel AISI 420
9	Handwheel	ASTM A536, 65-45-12 EN- GJS-450-10 EN 1563
10	O-ring	NBR
11	Body-bonnet gasket	EPDM
12	Stem bushing	Brass CuZn39Pb2
13	Gland seal	EPDM
14	Screw	Stainless steel (SS 316) A4; EN ISO 4762
15	Screw	Carbon steel zinc platec
16	Nut	Brass CuZn39Pb2
17	Washer	Brass CuZn39Pb2
18	Locknut	Brass CuZn39Pb2
19	Tapping bosses	ASTM A536, 65-45-12 EN- GJS-450-10 EN 1563

Partnumber		FM	DN		PN	L	H/H1	D	K	C	I	n	Weight					
ANSI Class 150	ISO 7005-2 PN16	-	[inch]	[mm]	[PSI]			ANSI/ISO	ANSI/ISO	ANSI/ISO	ANSI/ISO	ANSI/ISO	[kg]					
2260-0020-2E300	2260-0050-2E169	v	2	50	300	178	348/400	152	165	120,7	125	16,0	19	19,1	18	4	4	14.7
2260-0025-2E300	2260-0065-2E169	v	2 1/2	65		190	373/440	178	185	139,7	145	17,5	20	19,1	18	4	4	17.8
2260-0030-2E300	2260-0080-2E169	v	3	80		203	408/490	191	200	152,4	160	19,1	20	19,1	18	4	8	23.1
2260-0040-2E300	2260-0100-2E169	v	4	100		229	471/573	229	220	190,5	180	19,1	22	19,1	18	8	8	31.9
2260-0050-2E300	2260-0125-2E169	v	5	125		254	540/665	254	250	215,9	210	19,1	22	22,2	18	8	8	42.3
2260-0060-2E300	2260-0150-2E169	v	6	150		267	601/755	279	285	241,3	240	19,1	24	22,2	22	8	8	53.2
2260-0080-2E300	2260-0200-2E169	v	8	200		292	774/975	343	340	298,5	295	22,2	26	22,2	22	8	12	91.3
2260-0100-2E300	2260-0250-2E169	v	10	250		330	939/1193	406	405	362,0	355	23,8	29	25,4	26	12	12	134.7
2260-0120-2E300	2260-0300-2E169	v	12	300		356	1065/1370	483	460	431,8	410	25,4	32	25,4	26	12	12	200.1
2260-0140-2E250	2260-0350-2E169	v	14	350		250	381	1210/1560	533	520	478,3	470	25,4	35	25,4	26	12	16
2260-0160-2E250	2260-0400-2E169	v	16	400	408		1280/1680	597	580	539,8	525	25,4	38	28,8	30	12	16	356.3
2260-0180-2E250	2260-0450-2E169	v	18	450	432		1760/2210	635	640	577,9	585	25,4	42	28,8	30	16	20	531.6
2260-0200-2E250	2260-0500-2E169	v	20	500	457		1780/2280	699	715	635	650	28,6	46	31,8	33	20	20	566.73
2260-0240-2E250	2260-0600-2E169	v	24	600	508		1950/2550	813	840	749,3	770	30,1	52	34,9	36	20	20	785.1

We reserve the rights to modify the production program and the given data without separate notices due to the permanent company development.

MASTERVERVALVE OS&Y GxG

FIRE PROTECTION



Gate valve 2261

Product description:

- Body bonnet and wedge made of ductile cast iron EN 1563 EN- GJS-450-10
- Full bore gate valve
- EPDM full vulcanised wedge
- Wedge nut made of forged brass - replaceable
- Stainless steel (SS420) spindle with rolled thread - rising
- Gasket body-bonnet profiling type o-ring
- Body bonnet stainless steel screws protected by wax
- EPDM packing gland of spindle
- Epoxy coating minimum 250 microns according to AISI/AWWA C550
- Product according to FM1120/1130,
- Grooved ends according to AWWA C606 & ISO 6182
- Face to face according to ANSI B16.1
- Working Pressure 300 PSI
- Tapping bosses will have following sizes: 1/2" tapping boss: 2"(DN50) -5"(DN125), 3/4" tapping boss: 6"(DN150) -8"(DN200), 1" tapping boss: 10"(DN250) -12"(DN300)

Application:

Fire protection systems temperature from 0°C to +70°C

Optional types:

SS body bonnet screws,
With inductive or electromechanical sensors

Test control:

Water pressure test according to FM.
Seat: 1,5 x PN
Body: 2 x PN
Operation torque test

Assembling:

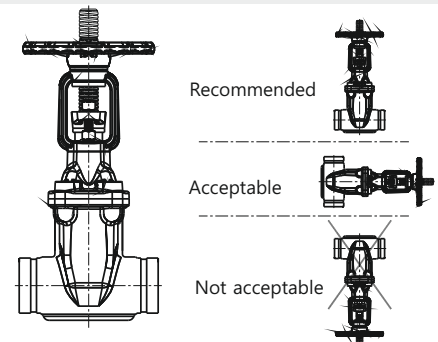

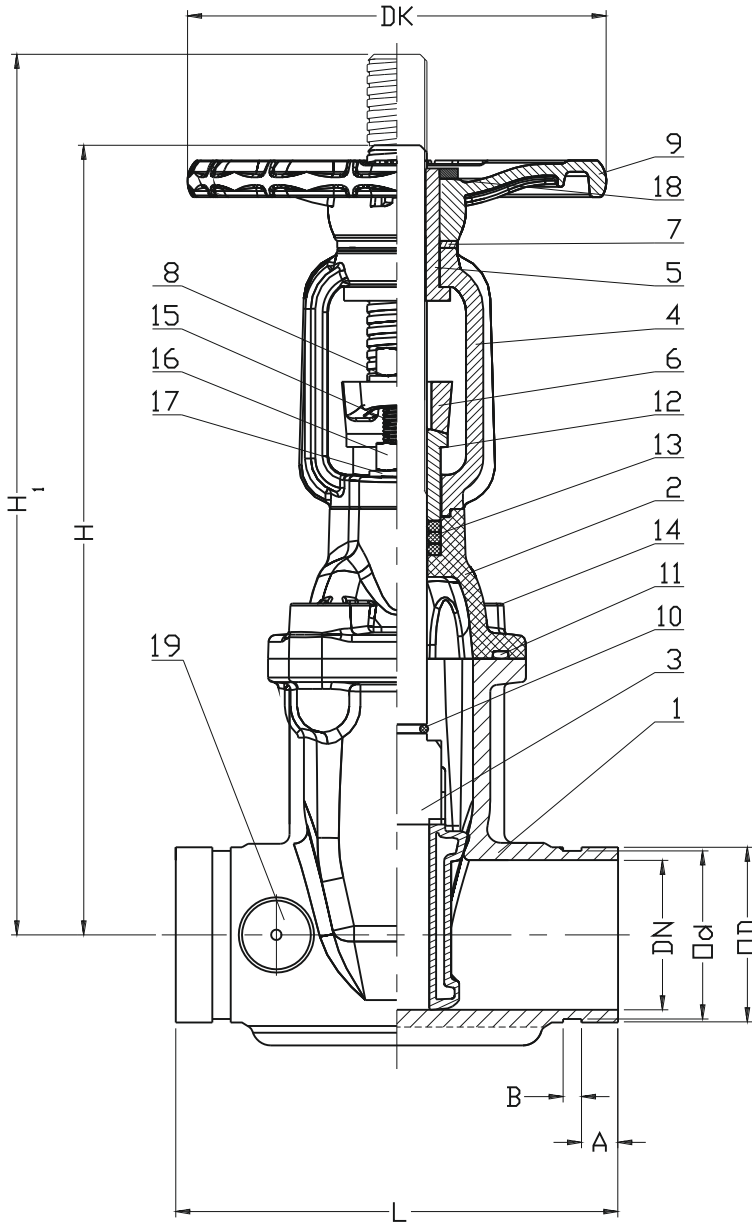

No.	Part	Material
1	Body	ASTM A536, 65-45-12 EN- GJS-450-10 EN 1563
2	Bonnet	ASTM A536, 65-45-12 EN- GJS-450-10 EN 1563
3	Wedge	ASTM A536, 65-45-12 EN- GJS-450-10 EN 1563 +EPDM
4	Yoke	ASTM A536, 65-45-12 EN- GJS-450-10 EN 1563
5	Threaded bushing	Brass CuZn39Pb2
6	Gland seal	ASTM A536, 65-45-12 EN- GJS-450-10 EN 1563
7	Spindle washer	Brass CuZn39Pb2
8	Spindle	Stainless steel AISI 420
9	Handwheel	ASTM A536, 65-45-12 EN- GJS-450-10 EN 1563
10	O-ring	NBR
11	Body-bonnet gasket	EPDM
12	Stem bushing	Brass CuZn39Pb2
13	Gland seal	EPDM
14	Screw	Stainless steel (SS 316) A4; EN ISO 4762
15	Screw	Carbon steel zinc platec
16	Nut	Brass CuZn39Pb2
17	Washer	Brass CuZn39Pb2
18	Locknut	Brass CuZn39Pb2
19	Tapping bosses	ASTM A536, 65-45-12 EN- GJS-450-10 EN 1563

Partnumber	FM	DN	PS	L	H/H1	OD	d	A	B	Weight
-	-	[mm]	[PSI]	[mm]						[kg]
2261-0050-2E300	v	50	300	178	348/400	60.3	57.15	15.88	7.92	11.33
2261-0065-2E300	v	65		190	373/440	76.1	72.26	15.88	7.92	12.47
2261-0073-2E300	v	2 1/2"		190	373/440	73	69.09	15.88	7.92	12.47
2261-0080-2E300	v	80		203	408/490	88.9	84.94	15.88	7.92	16.86
2261-0100-2E300	v	100		229	471/573	114.3	110.08	15.88	9.52	24.23
2261-0125-2E300	-	125		254	540/665	139.7	135.48	15.88	9.52	33.46
2261-0141-2E300	-	5"		254	540/665	141.3	137.03	15.88	9.52	33.46
2261-0150-2E300	v	150		267	601/755	168.3	163.96	15.88	9.52	41.32
2261-0165-2E300	v	6"		267	601/755	165.1	160.90	15.88	9.52	41.32
2261-0200-2E300	v	200		292	774/975	219.1	214.4	19.05	11.13	73.66
2261-0250-2E300	v	250		330	1029/1283	273	268.28	19.05	12.7	122.34
2261-0300-2E300	v	300		356	1065/1370	323.9	318.29	19.05	12.7	174.56

We reserve the rights to modify the production program and the given data without separate notices due to the permanent company development.

MASTERVALVE PIV FxF

**FIRE
PREVENTION**



Gate valve piv flanged 2265

Product description:

- Body bonnet and wedge made of ductile cast iron EN 1563 EN- GJS-450-10
- Full bore gate valve
- EPDM full vulcanised wedge
- Wedge nut made of forged brass - replaceable
- Stainless steel (SS420) spindle with rolled thread
- Gasket body-bonnet profiling type o-ring
- Body bonnet stainless steel screws protected by wax
- O-ring spindle sealing by NBR
- Under pressure replaceable o-ring packing
- Epoxy coating minimum 250 microns according to EN 14901
- Product according to FM1120/1130,
- Flange drilling according to ANSI CL125/150
- Face to face according to ANSI B16.1
- Working Pressure 300 PSI or PN16
- Tapping bosses will have following sizes: 1/2" tapping boss: 5"(DN125), 3/4" tapping boss: 6"(DN150) -8"(DN200), 1" tapping boss: 10"(DN250) -12"(DN300) 12"(DN300)

Application:

Fire protection systems temperature from 0°C to +70°C

Execution types:

SS body bonnet screws

Test control:

Water pressure test according to FM.
Seat: 1,5 x PN
Body: 2 x PN
Operation torque test

Assembling:

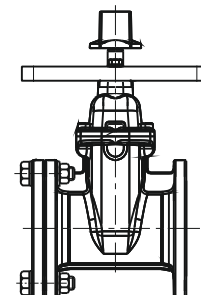

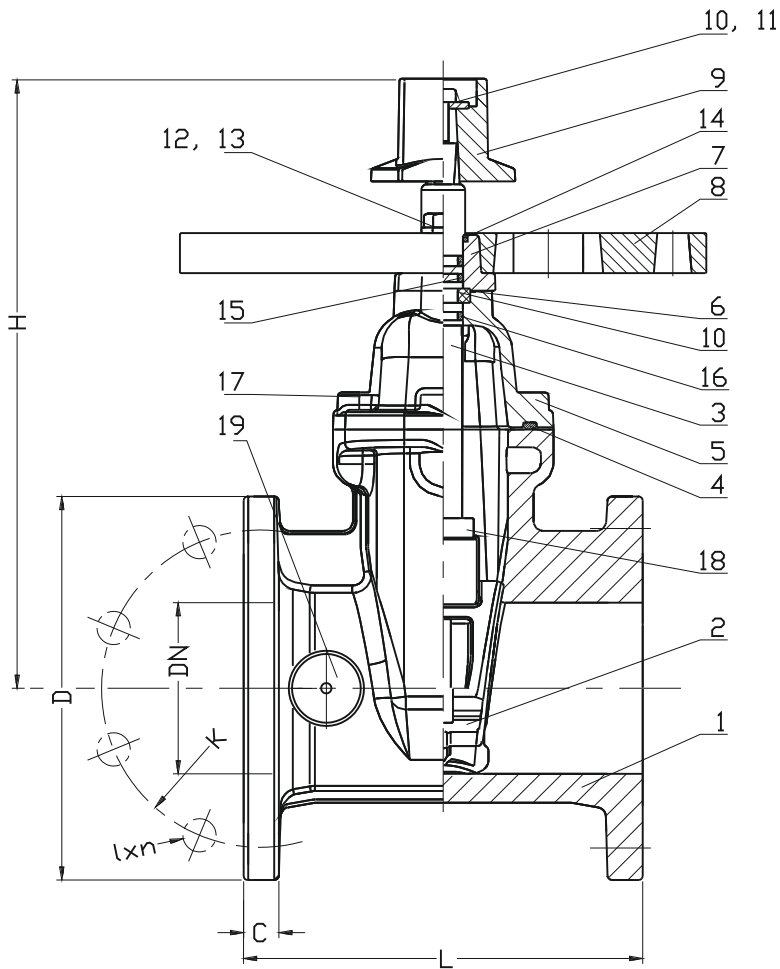

No.	Part	Material
1	Body	ASTM A536, 65-45-12 EN-GJS-450-10 EN 1563
2	Wedge Disc	ASTM A536, 65-45-12 EN-GJS-450-10 EN 1563 EPDM EN ISO 1629
3	Spindle	Stainless steel 1.4021 EN 10088-1
4	Body-bonnet gasket	EPDM EN 1629
5	Bonnet	ASTM A536, 65-45-12 EN-GJS-450-10 EN 1563
6	O-ring	NBR EN 1629
7	Gland	ASTM A536, 65-45-12 EN-GJS-450-10 EN 1563
8	Post flange	ASTM A536, 65-45-12 EN-GJS-450-10 EN 1563
9	Cap	ASTM A536, 65-45-12 EN-GJS-450-10 EN 1563
10	Screw	Carbon steel zinc platec
11	Flat washer	Carbon steel zinc platec
12	Nut	Carbon steel zinc platec
13	Flat washer	Carbon steel zinc platec
14	Ring wiper	EPDM EN 1629
15	O-ring	NBR EN 1629
16	O-ring	NBR EN 1629
17	Screw	Stainless steel (SS 304), A2, EN ISO 4762
18	Wedge nut	Brass CuZn39Pb2
19	Tapping bosses	ASTM A536, 65-45-12 EN-GJS-450-10 EN 1563

Partnumber		CE	FM	DN	PN	L	H	D		K		C		lxn		Weight
ANSI Class 150	ISO 7005-2 PN16			[inch] [mm]	[PSI]			ANSI/ISO		ANSI/ISO		ANSI/ISO		ANSI/ISO		[kg]
2265-0040-2E300	2265-0100-2E16	v	v	4" 100	100	229	395	229	220	190.5	180	19.1	22	8 x Ø19.1	8 x Ø18	27,5
2265-0050-2E300	2265-0125-2E16	v	v	5" 125	125	254	432	254	250	215.9	210	19.1	22	8 x Ø22.2	8 x Ø18	38,2
2265-0060-2E300	2265-0150-2E16	v	v	6" 150	150	267	475	279	285	241.3	240	19.1	24	8 x Ø22.2	8 x Ø22	45,7
2265-0080-2E300	2265-0200-2E16	v	v	8" 200	200	292	585	343	340	298.5	295	22.2	26	8 x Ø22.2	12 x Ø22	61
2265-0100-2E300	2265-0250-2E16	v	v	10" 250	250	330	656	406	405	362	355	23.8	29	12 x Ø25.4	12 x Ø26	99
2265-0120-2E300	2265-0300-2E16	v	v	12" 300	300	356	751	483	460	431.8	410	25.4	32	12 x Ø25.4	12 x Ø26	141

We reserve the rights to modify the production program and the given data without separate notices due to the permanent company development.

MASTERVALVE SWING GxG

**FIRE
PROTECTION**



Swing check valve
Grooved 6251

Product description:

- Compact design - high tightness
- Disc made of SS sealing made of EPDM o-rings
- Body made of ductile cast iron EN-GJS 450-10
- Epoxy coating minimum 250 microns according to EN 14901 and ANSI/AWWA C550
- Grooved ends according to AWWA C606 & ISO 6182
- Product according to FM, VdS

Application:

Fire protection systems temperature from 0°C to +70°C

Optional types:

SS seat ring,
Bronze plug,

Test control:

Water pressure test according to FM, VdS, EN-12266
Seat Leakage Test: 1,5 x PN
Body pressure test: 2 x PN

Assembling:

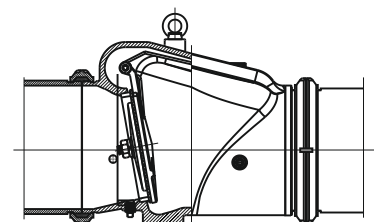

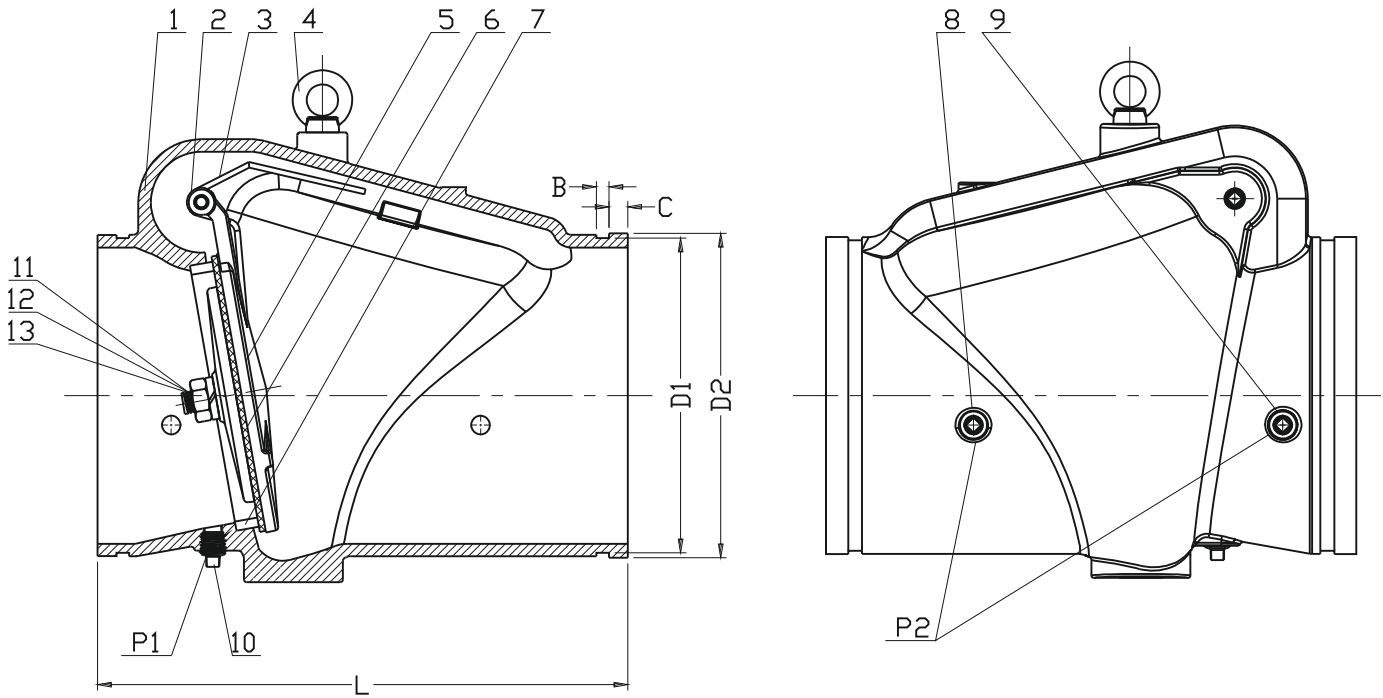

No.	Part	Material	No.	Part	Material
1	Body	ASTM A536, 65-45-12	6	Disc sealing ring	EPDM; EN ISO 1629
2	Hinge pin	Stainless steel 1.4021 EN 10088-1	7	Seat ring	ASTM B62 C83600
3	Spring	Stainless steel 1.4301 EN 10088-1	8, 9, 10,	Plug	Malleable iron galv anized
4	Eye bolt	Carbon steel zinc plated	11	Bolt	Stainless steel 1.4301 EN 10088-1
5	Disc	DN50-100 Stainless steel 1.4301	12	Washer	Stainless steel 1.4301 EN 10088-1
		DN150-300 ASTM A536, 65-45-12	13	Nut	Stainless steel 1.4301 EN 10088-1

Partnumber	CE	FM	VdS	DN		PN	L	D1	D2	B	C	P1	P2	Weight
				[inch]	[mm]									
6251-0050-8E300	v	v	v	2"	50	300	171	57.15	60.3	7.93	15.88	1/2-14NPT	3/8-18NPT	3.3
6251-0065-8E300	v	v	v	-	65		184	69.09	76.1	7.93	15.88	1/2-14NPT	3/8-18NPT	3.7
6251-0073-8E300	v	v	-	2 1/2"	-		184	69.09	73	7.93	15.88	1/2-14NPT	3/8-18NPT	3.7
6251-0080-8E300	v	v	v	3"	80		197	84.94	88.9	7.93	15.88	1/2-14NPT	3/8-18NPT	4.7
6251-0100-8E300	v	v	v	4"	100		210	110.08	114.3	9.53	15.88	1/2-14NPT	1/2-14NPT	7.5
6251-0125-8E300	v	-	v	-	125		248	137.03	139.7	9.53	15.88	1/2-14NPT	1/2-14NPT	10
6251-0141-8E300	v	-	-	5"	-		248	137.03	141	9.53	15.88	1/2-14NPT	1/2-14NPT	10
6251-0150-8E300	v	v	v	-	150		324	163.96	168.3	9.53	15.88	1/2-14NPT	1/2-14NPT	16.2
6251-0165-8E300	v	v	-	6"	-		324	163.96	165.1	9.53	15.88	1/2-14NPT	1/2-14NPT	16.2
6251-0200-8E300	v	v	v	8"	200		371	214.4	219.1	11.13	19.05	1/2-14NPT	1/2-14NPT	27
6251-0250-8E300	v	v	v	10"	250		457	268.28	273	12.7	19.05	1/2-14NPT	1/2-14NPT	52
6251-0300-8E300	v	v	v	12"	300		535	318.29	323.9	12.7	19.05	1/2-14NPT	1/2-14NPT	75.6

We reserve the rights to modify the production program and the given data without separate notices due to the permanent company development.